

② EXISTING FRONT ELEVATION
SCALE: 1/8" = 1'-0"

PROJECT DESCRIPTION

ALTERATION TO CONVERT THE EXISTING "KEANSBURG PHARMACY" RETAIL SPACE INTO FOUR NEW RETAIL SPACES.

DRAWING LIST

- EX-1 EXISTING GROUND FLOOR PLAN AND FRONT ELEVATION
- SK-1 PROPOSED GROUND FLOOR PLAN AND FRONT ELEVATION

No use, reproduction, or distribution may be made of this drawing or the concepts set forth herein without the prior consent of David Jablonka Architect, P.C.
Copyright © 2023 David Jablonka Architect, P.C.

DATE / REVISIONS:
OCTOBER 20, 2005 EX
SEPTEMBER 5, 2023 SD

NOTES:
[Signature]
David Jablonka, NJ Lic. No. 13347

PRINTED @ 44%

257 South Ridgewood Road
South Orange, NJ 07079
tel. 973.313.0088
JablonkaRA@aol.com
DAVID JABLONKA ARCHITECT, P.C.

PROJECT 2305
KEANSBURG PLAZA RENOVATION
199 MAIN STREET
KEANSBURG, NEW JERSEY 07734
BLOCK: 94 LOT: 54.01

DRAWING NAME & NO:
EXISTING PLAN AND ELEVATION
EX-1

BOROUGH OF KEANSBURG, NEW JERSEY
PLANNING BOARD APPROVAL

APPROVED BY THE PLANNING BOARD OF THE BOROUGH OF KEANSBURG, MONMOUTH COUNTY, NEW JERSEY, AT THEIR MEETING HELD ON:

DATE OF MEETING	DATE
CHAIRMAN	DATE
SECRETARY	DATE
TOWNSHIP ENGINEER	DATE



① EXISTING GROUND FLOOR PLAN
SCALE: 1/8" = 1'-0"

EXISTING TENANT AREA

BANK	2,867 SQ. FT.
KEANSBURG PHARMACY	10,096 SQ. FT.
DUNKIN DONUTS	2,285 SQ. FT.
TOTAL	15,248 SQ. FT.

EXISTING OCCUPANCY (BASED ON AREA)

BANK (USE GROUP B)	19 PEOPLE
KEANSBURG PHARMACY (USE GROUP M)	168 PEOPLE
DUNKIN DONUTS (USE GROUP A-2)	152 PEOPLE
TOTAL	339 PEOPLE

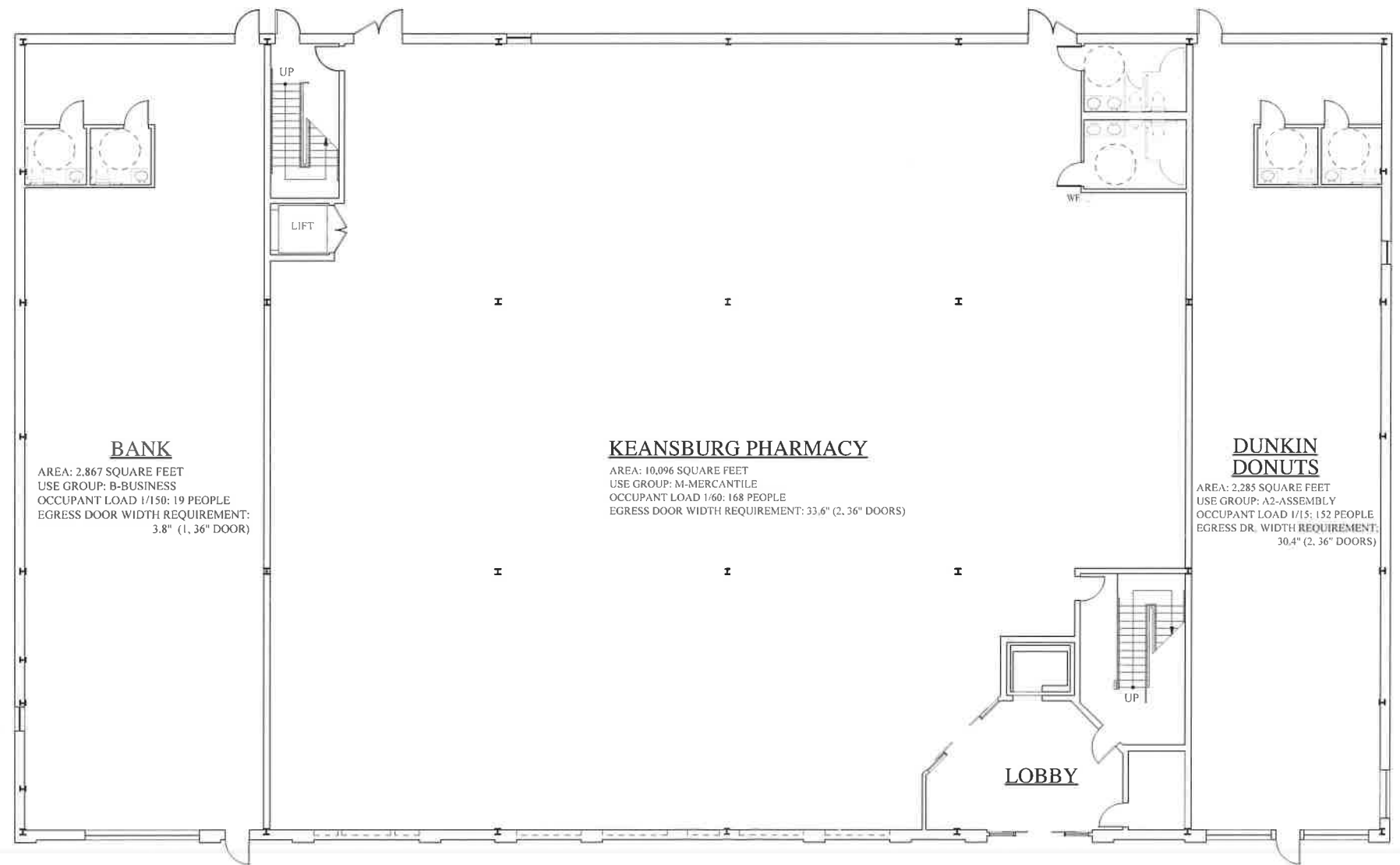

BANK
AREA: 2,867 SQUARE FEET
USE GROUP: B-BUSINESS
OCCUPANT LOAD 1/150: 19 PEOPLE
EGRESS DOOR WIDTH REQUIREMENT:
3.8" (1.36" DOOR)

KEANSBURG PHARMACY
AREA: 10,096 SQUARE FEET
USE GROUP: M-MERCANTILE
OCCUPANT LOAD 1/60: 168 PEOPLE
EGRESS DOOR WIDTH REQUIREMENT: 33.6" (2.36" DOORS)

DUNKIN DONUTS
AREA: 2,285 SQUARE FEET
USE GROUP: A2-ASSEMBLY
OCCUPANT LOAD 1/15: 152 PEOPLE
EGRESS DR. WIDTH REQUIREMENT:
30.4" (2.36" DOORS)

LOBBY

DRIVE THROUGH

DRIVE THROUGH